

Specifications

Model Number: W350

Interactive Water Effect: Shall be a flat spray effect emanating from the inside of the ring.

Shaft: 3" type 304 stainless steel pipe with full radius bend and machined type 304 base plate.

Special Theming: Hard foam core with a structural elastomeric polymer outer shell.

Anchor Base: Type 304 stainless steel machined to mate with shaft base plate with grounding connection and 2" FPT inlet. Supplied with 4, 3/8" x 12" x 2" 18/8 stainless steel anchor bolts with two leveling nuts and washers per bolt and wood pour template.

Closed End Base: Supplied with 2 stainless steel concrete anchors, 18/8 stainless steel tamper-resistant screws, and a threaded drain plug.

Gasket: 70 durometer EPDM o-ring.

Fasteners: Tamper-resistant 18/8 stainless steel.

Finish: Textured elastomeric urethane with a UV and chlorine resistant sealer coat.

Color: (Specify red, dark blue, light blue, yellow, green, orange, or purple.)

Nozzles: 6 stainless steel flat spray jets.

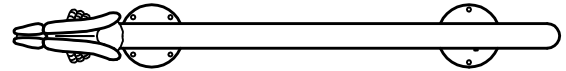

Optional Adders:

Wireless Activator Button (-SW)

Transmitter: Solid state with encoded signal and integral omni-directional antenna.

Activator Power: 3 VDC lithium battery (CR2477).

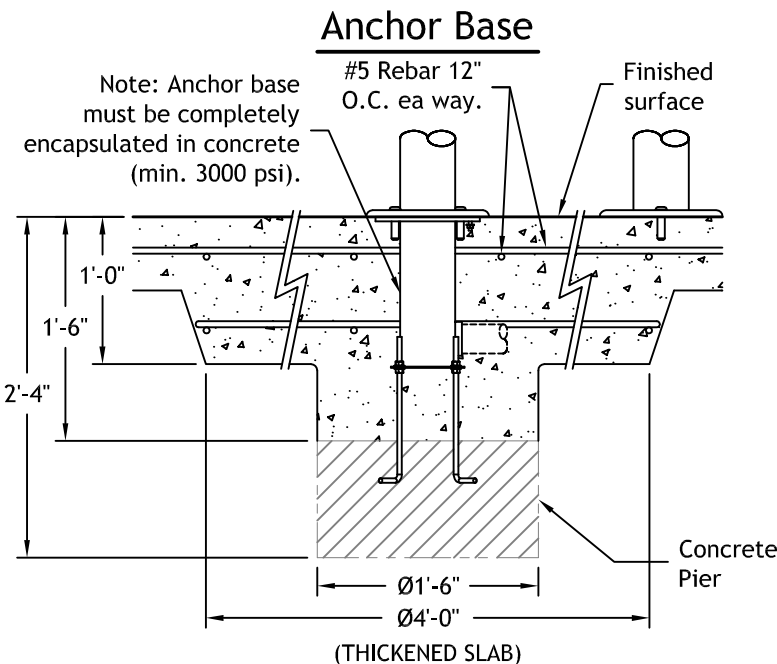
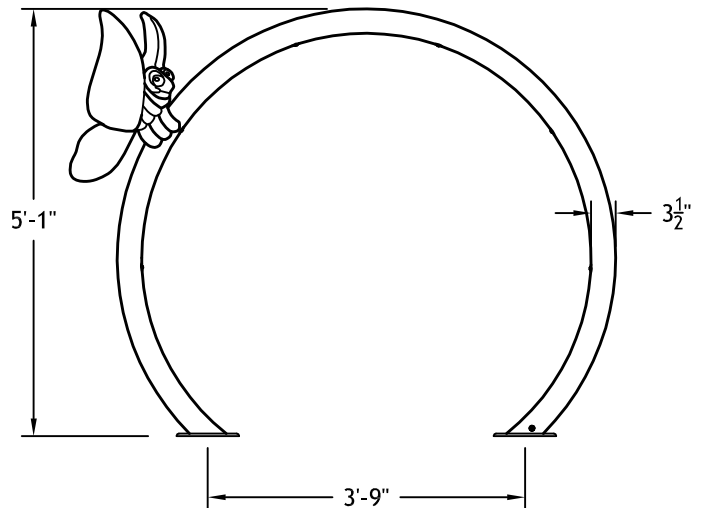

Hydraulic Requirements

W350

GPM	psi
10	10



Flutterby Ring™